

# The Estate Agents People Recommend



3 Caversham Villas The Street, Hurst,  
RG10 0DF

Price guide £425,000

A character two bedroom, two bathroom Victorian end terrace cottage with a delightful cosy sitting room with wood burner and separate dining room. The cottage has hardwood or tiled floors to the ground floor, gas central heating to radiators and a mature garden to the rear with unrestricted on street parking to the front.

The picturesque village boasts a close-knit community and essential amenities within easy reach. Hurst Primary School, a post office, local shop, bakery and public houses are all just a leisurely stroll away, ensuring convenience for daily needs.

Twyford is about 2 miles away and enjoys a variety of facilities including Waitrose, Tesco, Costa and many other individual retailers, various restaurants and public houses and a mainline station serving London Paddington and Reading with the benefit of the Elizabeth line.

The property is offered for sale with NO ONWARD CHAIN.

EPC rating - D  
Council tax band - D



t: 0118 934 0027  
e: [twyford@wentworthea.com](mailto:twyford@wentworthea.com)  
w: [wentworthea.com](http://wentworthea.com)



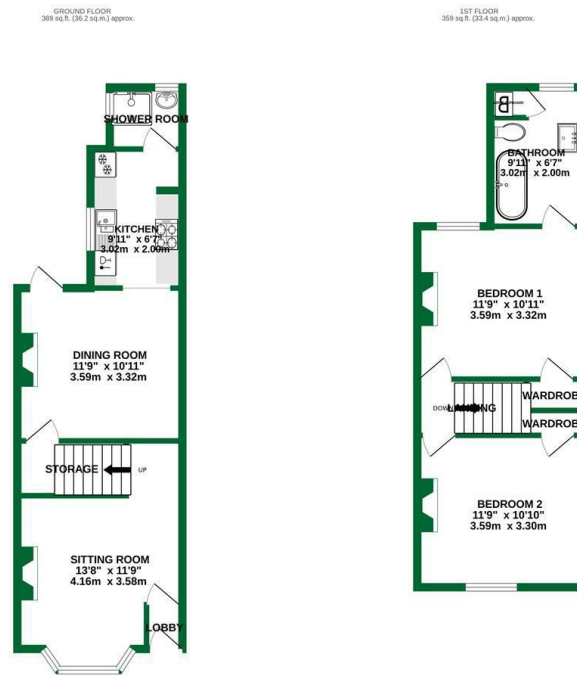

TOTAL FLOOR AREA: 748 sq ft. (69.5 sq.m.) approx.  
 Whilst every attempt has been made to ensure the accuracy of the above contained floor measurements, of doors, windows, stairs and any other items are approximate and no responsibility is taken for any errors, omissions or mis-statements. This plan is for guidance purposes only and should be used in conjunction with any prospective purchaser. The services, systems and appliances shown have not been tested and no guarantee as to their operability or efficiency can be given.  
 Made with floorplan 120224

**Important Notice 1. Particulars:** These particulars are not an offer or contract, nor part of one. You should not rely on statements by Wentworth Estate Agents in the particulars or by word of mouth or in writing ("information") as being factually accurate about the property, its condition or its value. Neither Wentworth Estate Agents nor any joint agent has any authority to make any representations about the property, and accordingly any information given is entirely without responsibility on the part of the agents, seller(s) or lessor(s). 2. Photos etc: The photographs show only certain parts of the property as they appeared at the time they were taken. Areas, measurements and distances given are approximate only. 3.Regulations etc: Any reference to alterations to, or use of, any part of the property does not mean that any necessary planning, building regulations or other consent has been obtained. A buyer or lessee must find out by inspection or in other ways that these matters have been properly dealt with and that all information is correct.

